

SESAME TWIN-L

FULL-HEIGHT TURNSTILE

Sesame Twin-L is a so-called double turnstile. This pedestrian security gate benefits with significant space and cost saving in comparison to two single turnstiles installed one near another.

It is a perfect fit for applications with highest intensity of pedestrian traffic, like stadiums or large factories.

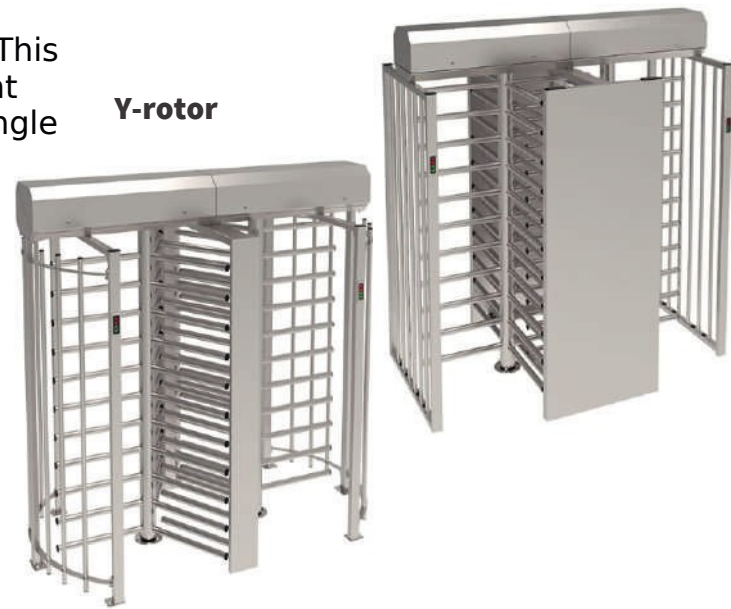

MODEL OF THE FULL-HEIGHT TURNSTILE SERIES

GUARANTEES FULL PROTECTION OF THE TERRITORY

 X-rotor: 570
Y-rotor: 650
mm
PASSAGE WIDTH

 40
pers/min
SINGLE ACCESS

 60
pers/min
FREE ACCESS

 IP 41-65*
PROTECTIVE LEVEL

 BI-DIRECTIONAL

Key advantages

- Can be supplied as fully welded or in disassembled condition which has perfect effect to transportation cost
- Depending on installation place conditions and customer's requirements can be produced of different types of material, for outside/ inside applications, with Y-rotor/ X-rotor, etc
- Low noise system operation
- Successful combination of affordable price and high quality
- Wide range of accessories
- Steadfast housing suitable for high traffic areas
- Can be integrated with any type of access control systems
- Low power consumption
- Wired remote control panel is in a standard kit
- In case of power failure rotor unlocked in both directions (fail-safe)

Options

- OEM / logo application
- Enlargement of passage width up to 800 mm
- Heating/cooling option
- Weather pack - IP 54/IP 65
- Canopy/ Roof
- Lane light
- Ramped base mobile/ Square, perforated platform
- Ground frame for installation
- Fail-secure mode under request
- Emergency door

* available upon request

Technical Specifications:

	X-type - 90°	Y-type - 120°
Unit width, mm	2060	2234
Unit length, mm	1341	1158
Unit height, mm	2300	2300
Passage width, mm	570	650
Mechanism	servo-driven	
Standard housing	Brushed SS AISI 304	
Available housing	Brushed SS AISI 316 Polished SS AISI 304 Polished SS AISI 316 Hot dip galvanized Powder coated RAL	



Controlled by:

- access control system;
- manual control

When power goes OFF both directions are free.

Electrical Specifications:

- Voltage:
 - from the AC (100-240)V, 50/60Hz;
 - from a DC source 12 V;
- Maximum power consumption 160 W per pass.

X-rotor

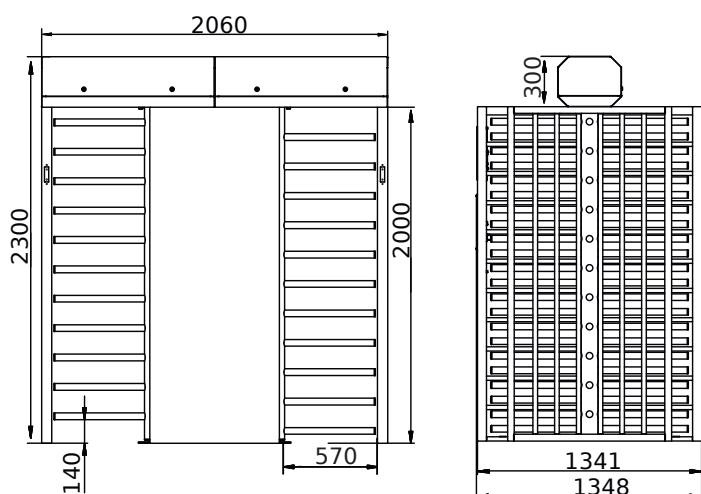

Y-rotor

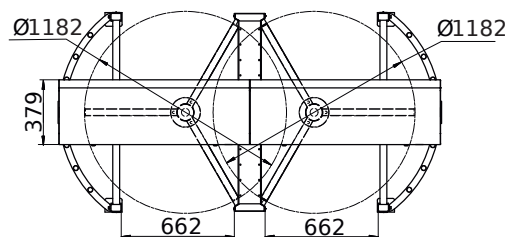
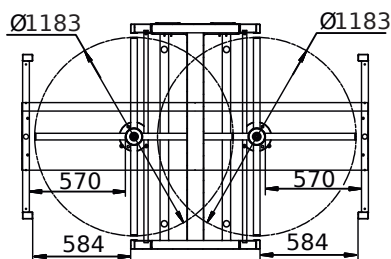
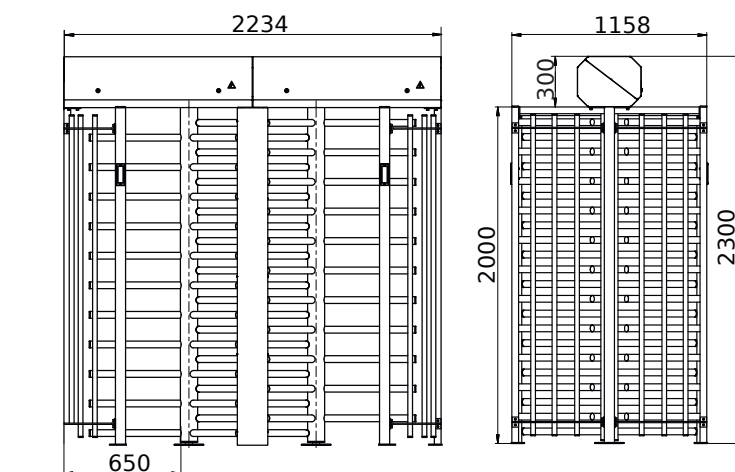

Recommended installation areas:

- Sport Complexes
- Recreation areas
- Governmental Institutions
- Production sites (Industrial Plants)
- Commercial areas
- Education Institutions
- Military Bases
- Urban areas
- Financial Institutions and others